



Innovative Sealing Technology



GAPI

SEALING SOLUTIONS PARTNER

Quality, Reliability, and Availability



Composite Guide Rings

Improve the performance of hydraulic cylinders with our guide rings.



Gapi LTD Advantage



High-quality seals at reasonable prices.

At Gapi LTD, we specialize in delivering an extensive suite of sealing solutions meticulously engineered to fulfill a broad spectrum of industrial specifications, ensuring superior quality and cost-efficiency. Our product lineup encompasses:

- **S0** (Phenolic Resin Cotton Fabric): Demonstrates exceptional thermal stability, suitable for operational conditions with temperatures between -60°C to 150°C .
- **S1** (Phenolic Resin Polyester with PTFE): Provides unparalleled chemical compatibility with aggressive substances, maintaining operational efficiency within a temperature range of -60°C to 150°C .
- **S3** (Phenolic Resin Polyester with Graphite): Ensures enhanced wear resistance, optimally performing within temperatures from -50°C to 150°C .

With an extensive stock readily available, we guarantee expedited delivery of various dimensions meticulously tailored to your specific application requirements. Our steadfast commitment to quality and cost-effectiveness ensures that our clients receive premium sealing solutions without compromising performance.



Engineered Thermoplastic Resin



- **Phenolic resin Cotton fabric reinforced**
- Self-lubrication, good mechanical properties, good dimensional stability and chemical resistance. Excellent in water and in abrasion resistance. Excellent against impact. Main applications are wear rings for all kinds of cylinders, sliding bearings and bushes.
- Service Temperature Range : **-60°C to +150°C**
- Shore Hardness: **80 D**



- **Phenolic resin polyester fabric reinforced with PTFE.**
- Self-lubrication, good mechanical properties, good dimensional stability and chemical resistance. Excellent in water and in abrasion resistance. Excellent against impact. Main applications are wear rings for all kinds of cylinders, sliding bearings and bushes.
- Service Temperature Range : **-60°C to +150°C.**
- Shore Hardness: **75 D**



- **Phenolic resin polyester fabric reinforced with GRAPHITE.**
- Excellent dimensional stability and abrasion resistance. Self-lubrication and wide chemical resistance. Excellent in water. Main applications are wear rings for all kinds of cylinder's sliding bearings and bushes.
- Service Temperature Range : **-50°C to +150°C.**
- Shore Hardness: **80 D**

Composite Guide Rings

Enhanced Performance Features



Precision Engineering

The HPW guide ring is expertly designed to primarily prevent metal-to-metal contact and ensure proper alignment of the rod. It employs advanced elastomeric materials that offer superior resistance to high-pressure environments and extreme temperatures.

Versatile Applications

HPW guide rings boost hydraulic cylinder efficiency by reducing friction and leaks. Gapi, a top manufacturer, uses advanced materials for durability, enhancing performance, cutting maintenance costs, and meeting industry standards for smooth operations.

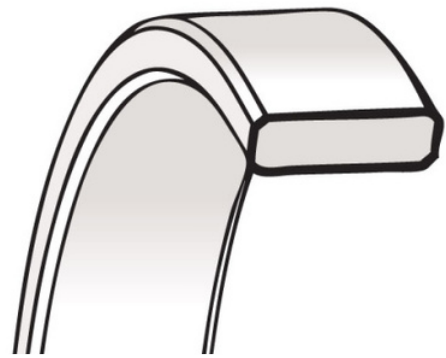

Functional Design

These guide rings significantly improve the durability and functionality of hydraulic cylinders, fostering both greater efficiency and extended longevity.

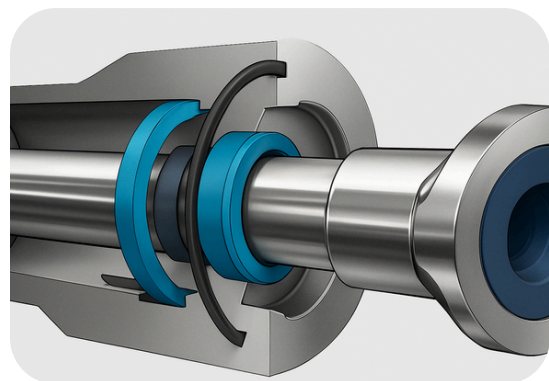

Hydraulic Guide Ring



Enhanced Performance and Durability Solutions

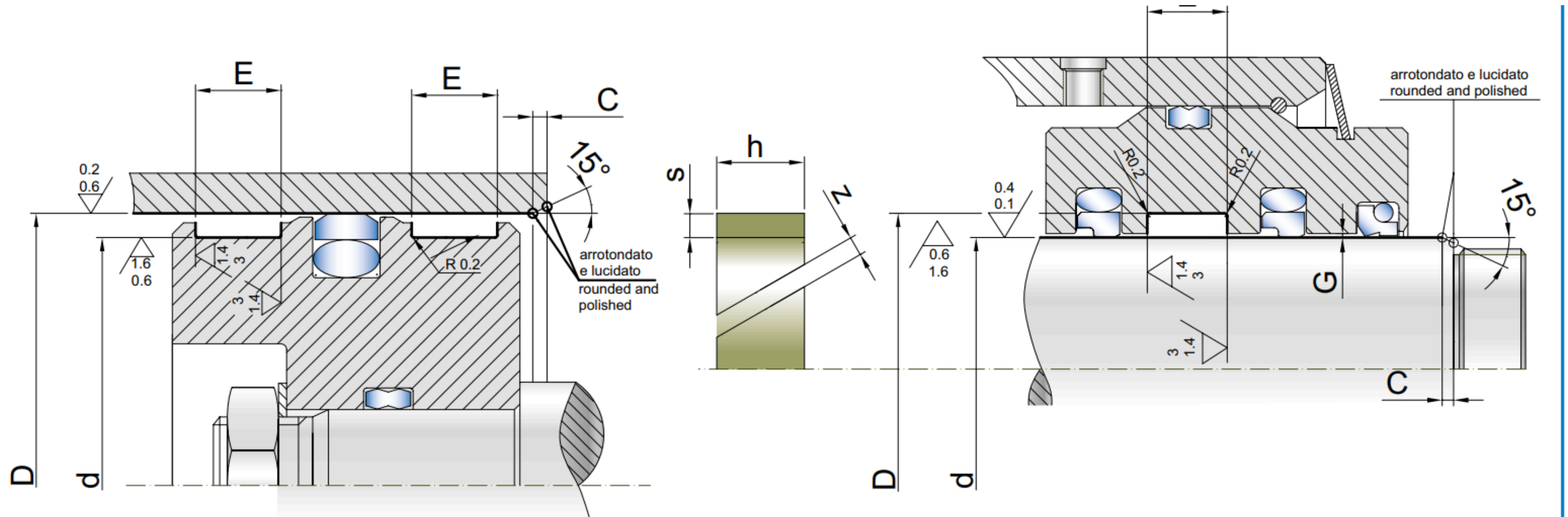

Standard Dimensions & Availability

Standard Dimensions & Availability

- Our HPW Guide Rings are available in a complete range of standard sizes, engineered to fit the most common hydraulic and pneumatic cylinder configurations.
- HPW guide rings: standard sizes listed below.
- This page shows what's commonly available.
- See the previous slide for precise dimensions

d _{f8}	D _{H9}	E _{+0.2}	E _{+0.2}	E _{+0.2}	ART / ITEM		
40,0	45,0	5,6	9,7		HPW 0400	0450	056-097
45,0	50,0	5,6	9,7		HPW 0450	0500	056-097
50,0	55,0	5,6	9,7		HPW 0500	0550	056-097
55,0	60,0	5,6	9,7		HPW 0550	0600	056-097
56,0	61,0	5,6	9,7		HPW 0560	0610	056-097
60,0	65,0	5,6	9,7		HPW 0600	0650	056-097
65,0	70,0	5,6	9,7		HPW 0650	0700	056-097
70,0	75,0	5,6	9,7		HPW 0700	0750	056-097
75,0	80,0	5,6	9,7		HPW 0750	0800	056-097
80,0	85,0	9,7	12,8	15,0	HPW 0800	0850	097-128-150
85,0	90,0	9,7	12,8	15,0	HPW 0850	0900	097-128-150
90,0	95,0	9,7	12,8	15,0	HPW 0900	0950	097-128-150
95,0	100,0	9,7	12,8	15,0	HPW 0950	1000	097-128-150
100,0	105,0	9,7	12,8	15,0	HPW 1000	1050	097-128-150
105,0	110,0	9,7	12,8	15,0	HPW 1050	1100	097-128-150
110,0	115,0	9,7	12,8	15,0	HPW 1100	1150	097-128-150
115,0	120,0	9,7	12,8	15,0	HPW 1150	1200	097-128-150
120,0	125,0	9,7	12,8	15,0	HPW 1200	1250	097-128-150
125,0	130,0	9,7	12,8	15,0	HPW 1250	1300	097-128-150
130,0	135,0	9,7	12,8	15,0	HPW 1300	1350	097-128-150
135,0	140,0	9,7	12,8	15,0	HPW 1350	1400	097-128-150
140,0	145,0	9,7	12,8	15,0	HPW 1400	1450	097-128-150
145,0	150,0	9,7	12,8	15,0	HPW 1450	1500	097-128-150
150,0	155,0	9,7	12,8	15,0	HPW 1500	1550	097-128-150
155,0	160,0	9,7	12,8	15,0	HPW 1550	1600	097-128-150
160,0	165,0	9,7	12,8	15,0	HPW 1600	1650	097-128-150
165,0	170,0	9,7	12,8	15,0	HPW 1650	1700	097-128-150
170,0	175,0	9,7	12,8	15,0	HPW 1700	1750	097-128-150
175,0	180,0	9,7	12,8	15,0	HPW 1750	1800	097-128-150
180,0	185,0	9,7	12,8	15,0	HPW 1800	1850	097-128-150
185,0	190,0	9,7	12,8	15,0	HPW 1850	1900	097-128-150
190,0	195,0	9,7	12,8	15,0	HPW 1900	1950	097-128-150
195,0	200,0	9,7	12,8	15,0	HPW 1950	2000	097-128-150
200,0	205,0	9,7	12,8	15,0	HPW 2000	2050	097-128-150
205,0	210,0	9,7	12,8	15,0	HPW 2050	2100	097-128-150
210,0	215,0	9,7	12,8	15,0	HPW 2100	2150	097-128-150
215,0	220,0	\	15,0	25,0	HPW 2150	2200	150-250
220,0	225,0	\	15,0	25,0	HPW 2200	2250	150-250
225,0	230,0	\	15,0	25,0	HPW 2250	2300	150-250
230,0	235,0	\	15,0	25,0	HPW 2300	2350	150-250
235,0	240,0	\	15,0	25,0	HPW 2350	2400	150-250
240,0	245,0	\	15,0	25,0	HPW 2400	2450	150-250
245,0	250,0	\	15,0	25,0	HPW 2450	2500	150-250
250,0	255,0	\	15,0	25,0	HPW 2500	2550	150-250

Comprehensive Sealing Solutions

Technical Support

- Expert engineering team providing guidance from concept to completion.
- In-depth knowledge of materials and sealing technologies.
- Assistance with design optimisation, testing, and troubleshooting.

Custom Solutions

- Tailor-made sealing solutions for unique applications.
- In-house design and manufacturing capabilities.
- Wide range of materials to meet demanding conditions and industry standards.

After-Sales Customer Support

- Dedicated team ensuring long-term product performance.
- Installation and maintenance guidance available.
- Fast, reliable response to customer queries and technical issues.





Contact Us

We're Here to Help



Phone

01709 378181

Email

sales@gapi.co.uk

Website

www.gapi.co.uk

Address

Centurion Business Park Bessemer Way,
Rotherham S60 1FB

